

## SWEEPING BUCKETS

Available in 5 different models, the CNH sweeping bucket can be equipped with a brush kit made of polypropylene for standard use or polypropylene+steel to tackle particularly abrasive surfaces. Thanks to its strong frame and HB400 high-strength steel blade, it performs extremely well on all kinds of surfaces, even in the presence of the most stubborn mud.

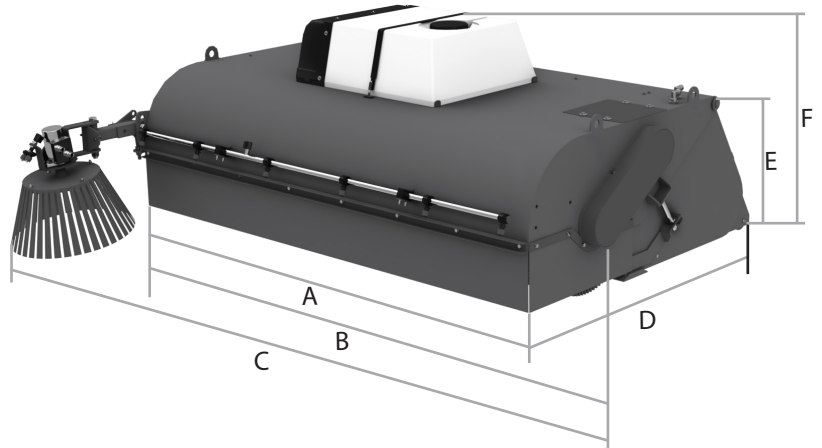

| Model                      | BSE 140 | BSE 160 | BSE 180 | BSE 210 | BSE 230 |
|----------------------------|---------|---------|---------|---------|---------|
| A (mm)                     | 1400    | 1600    | 1800    | 2100    | 2300    |
| B (mm)                     | 1550    | 1750    | 1950    | 2250    | 2450    |
| C (mm)                     | 1700    | 1900    | 2100    | 2400    | 2600    |
| D (mm)                     | 1390    | 1390    | 1390    | 1390    | 1390    |
| E (mm)                     | 625     | 625     | 625     | 625     | 625     |
| F (mm)                     | 860     | 860     | 860     | 860     | 860     |
| Weight when empty (kg)     | 300     | 330     | 360     | 415     | 450     |
| Max. capacity (l)          | 380     | 440     | 490     | 570     | 630     |
| Diameter of brushes (mm)   | 550     | 550     | 550     | 550     | 550     |
| Brush elements (mm)        | 28+2    | 32+2    | 37+2    | 43+2    | 48+2    |
| Max. oil flow rate (l/min) | 50      | 50      | 60      | 70      | 70      |
| Max. pressure (bar)        | 180     | 180     | 180     | 180     | 180     |

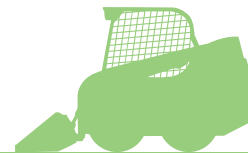

## TECHNICAL SPECIFICATIONS

- Bolted reversible HB400 blade.
- Motor with square flange and disc distribution.
- Flow reducers.
- Polypropylene or polypropylene+steel brush kit.

## ACCESSORIES

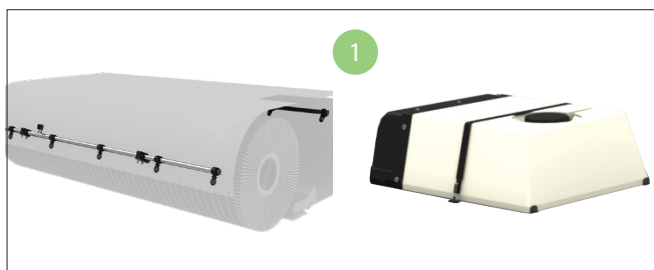

- 1** Dust abatement system:  
The pressurised water system with tank allows for the abatement of the dust generated during machining. Sprayers are installed both inside and outside the bucket.

|       |         |         |         |         |         |
|-------|---------|---------|---------|---------|---------|
| Model | BSE 140 | BSE 160 | BSE 180 | BSE 210 | BSE 230 |
|-------|---------|---------|---------|---------|---------|

Side brush:

**2**

|       |         |         |         |         |         |
|-------|---------|---------|---------|---------|---------|
| Model | BSE 140 | BSE 160 | BSE 180 | BSE 210 | BSE 230 |
|-------|---------|---------|---------|---------|---------|

Sprayers for side brush:

**3**

|       |         |         |         |         |         |
|-------|---------|---------|---------|---------|---------|
| Model | BSE 140 | BSE 160 | BSE 180 | BSE 210 | BSE 230 |
|-------|---------|---------|---------|---------|---------|